

**BUILDING-STRUCTURE INVENTORY FORM**

DIVISION FOR HISTORIC PRESERVATION  
 NEW YORK STATE PARKS AND RECREATION  
 ALBANY, NEW YORK (518) 474-0479

FOR OFFICE USE ONLY

UNIQUE SITE NO. 019-40-0030  
 QUAD 621440/4960430  
 SERIES 34 ACRES  
 NEG. NO. \_\_\_\_\_

N. R. \_\_\_\_\_

YOUR NAME: C.D. DeRoche/Russ Bordeau DATE: 9/78

YOUR ADDRESS: C.C.H.A., Plattsburgh, NY TELEPHONE: 518-561-0340

JAN 0 5 1979

ORGANIZATION (if any): H.A.D.A.C., P.O. Box 274, Hurley, New York

\*\*\*\*\*  
**IDENTIFICATION #4**

1. BUILDING NAME(S): S.F. Vilas Home FOR AGED & INFIRMED LADIES
2. COUNTY: Clinton TOWN/CITY: Plattsburgh VILLAGE: \_\_\_\_\_
3. STREET LOCATION: Northwest Corner of Beekman and Cornelia Streets
4. OWNERSHIP: a. public  b. private
5. PRESENT OWNER: S.F. Vilas Home ADDRESS: Beekman and Cornelia Streets
6. USE: Original: residence for aged ladies Present: same
7. ACCESSIBILITY TO PUBLIC: Exterior visible from public road: Yes  No   
 Interior accessible: Explain No

**DESCRIPTION**

8. BUILDING MATERIAL: a. clapboard  b. stone  c. brick  d. board and batten   
 e. cobblestone  f. shingles  g. stucco  other: \_\_\_\_\_
9. STRUCTURAL SYSTEM: a. wood frame with interlocking joints   
 (if known) b. wood frame with light members   
 c. masonry load bearing walls   
 d. metal (explain) \_\_\_\_\_  
 e. other \_\_\_\_\_
10. CONDITION: a. excellent  b. good  c. fair  d. deteriorated
11. INTEGRITY: a. original site  b. moved  if so, when? \_\_\_\_\_  
 c. list major alterations and dates (if known):

\* 1 storey shed-roof clapboard addition at rear.



FRONT (EAST) FACADE LOOKING WEST

13. MAP:

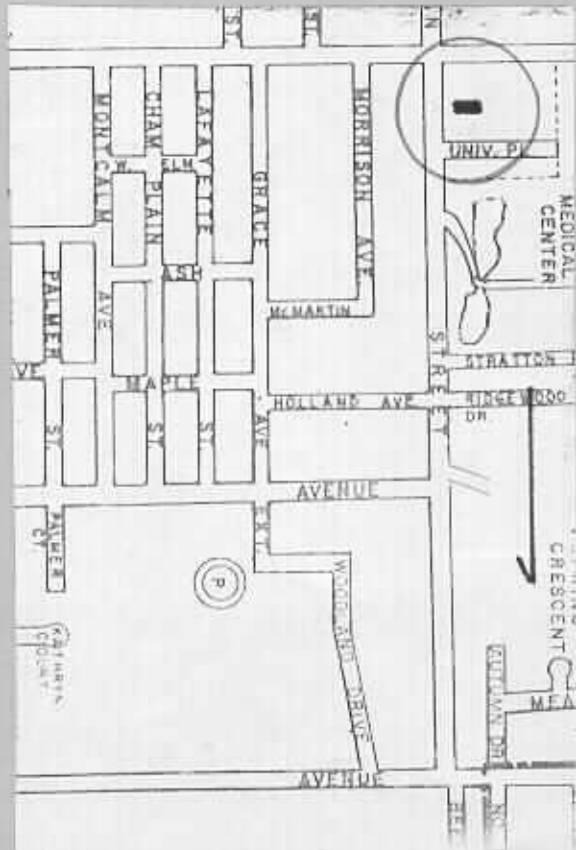

14. THREATS TO BUILDING: a. none known  b. zoning  c. roads   
 d. developers  e. deterioration   
 f. other: \_\_\_\_\_
15. RELATED OUTBUILDINGS AND PROPERTY:  
 a. barn  b. carriage house  c. garage   
 d. privy  e. shed  f. greenhouse   
 g. shop  h. gardens   
 i. landscape features: \_\_\_\_\_  
 j. other: \_\_\_\_\_
16. SURROUNDINGS OF THE BUILDING (check more than one if necessary):  
 a. open land  b. woodland   
 c. scattered buildings   
 d. densely built-up  e. commercial   
 f. industrial  g. residential   
 h. other: school/hospital

17. INTERRELATIONSHIP OF BUILDING AND SURROUNDINGS:

(Indicate if building or structure is in an historic district)

East (facade): residences opposite; North: residences opposite; West: parking lot, residences, offices; South: State University and parking lot.

*THE NOMINATED PROPERTY IS THE HISTORIC PARCEL ENCOMPASSED BY PLESSON TRACTORY BOUNDARIES DELINEATED ON THE ATTACHED TAX MAP.*

18. OTHER NOTABLE FEATURES OF BUILDING AND SITE (including interior features if known):  
 Notable features of this monumental structure are its truncated hipped roofs with cross gable wings, string course, corbelled decorative chimneys, moulded cornices, bands of colored brickwork, scalloped shingled pillars, Doric columns, polygonal bays, arched windows and recessed porches (one beneath an arch).

**SIGNIFICANCE**

19. DATE OF INITIAL CONSTRUCTION: 1889 on cornerstone (southside)  
 ARCHITECT: MARCUS F. FRIEDRICK CUMMINGS  
 BUILDER: Harriet Hunt Vilas

20. HISTORICAL AND ARCHITECTURAL IMPORTANCE: The S.F. Vilas Home for Aged and Infirm Ladies was erected and endowed by Mrs. Vilas in memory of her husband, Samuel F. Vilas. It was dedicated on March 3, 1890 and was "well adapted to promote the comfort and convenience of its occupants." There are three floors with accommodations for 44 people who must be residents of Clinton, Essex or Franklin counties. This building is one of the earliest institutional structures in the city and a fine imposing example of Queen Anne architecture in the locale.

21. SOURCES: Plattsburgh Daily Press - Souvenir Industrial Edition (1897), p. 34.

22. THEME: Late 19th century institutional architecture.

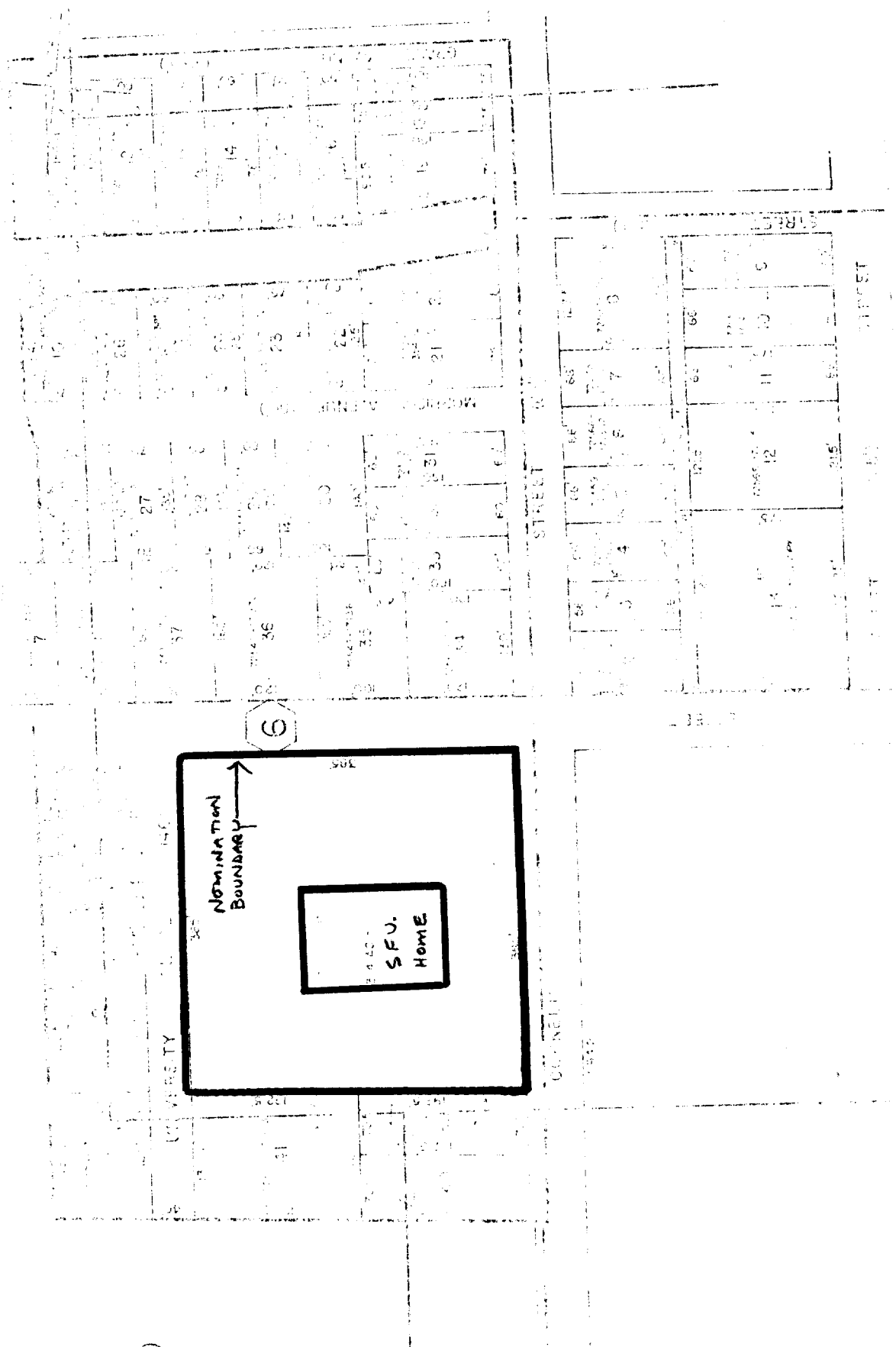

PLATTSBURGH CITY MULTIPLE RESOURCE AREA  
 S.F. VILAS HOME FOR AGED & INFIRMED LADIES  
 N.W. CORNER BEEKMAN AND CORNELIA STS.  
 CLINTON COUNTY  
 PLATTSBURGH, NY



**TAX MAP**

3.4 ACRES

SCALE: 1"=175'

PLATTSBURGH CITY MULTIPLE RESOURCE AREA  
S.F. VILAS HOME FOR AGED & INFIRMED LADIES  
N.W. CORNER BEEKMAN AND CORNELIA STS.  
CLINTON COUNTY  
PLATTSBURGH, NY



SOUTH FAÇADE, LOOKING NORTH