

ADDENDUM NO. 2

CITY OF PLATTSBURGH DOWNTOWN REVITALIZATION INITIATIVE ARTS PARK

THIS ADDENDUM, ISSUED TO BID DOCUMENT HOLDERS OF RECORD, INDICATES CHANGES TO THE BID DOCUMENTS DATED OCTOBER 26, 2020. ALL CHANGES DESCRIBED HEREIN SHALL BE INCORPORATED INTO THE CONTRACTOR'S BID PROPOSAL. THIS ADDENDUM IS PART OF THE CONTRACT DOCUMENTS. ACKNOWLEDGEMENT OF RECEIPT OF THIS ADDENDUM IS REQUIRED ON THE RESPECTIVE BID FORM.

SA PROJECT # 2018-039.10

November 13, 2020

Prepared By:

Saratoga Associates
Landscape Architects, Architects, Engineers, and Planners, P.C.
21 Congress Street
Saratoga Springs, New York 12866

The following notes, changes, additions, and replacements shall be incorporated into the Project Manual or drawings as applicable:

ITEM 1. CONTRACTOR QUESTIONS

1. The insurance requirements mention Contractor to have pollution insurance. Is Contractor required to have this?
Yes, pollution insurance is required.
2. Re: L601: Which contract is responsible for light pole and bollard concrete bases?
Concrete bases are the responsibility of the Electrical Contractor – Pay Item 12C.
3. Re: C100: Per Summary of Electrical Work, Note 3.01A: all excavation and backfill is by the GC contract. Per Electrical contract bid form there are two unit costs for Excavation and Backfill. Which contract is responsible for excavation and backfill?
See Addendum 1, Item 3, Question 4.
4. Re: C100: Vista LED in-grade lights have a max. ¾” conduit hub. C100 calls for 2” PVC conduits which will not fit.
Is it acceptable to provide ¾” PVC conduit for all LED in-grade lights?
Yes, provide ¾” PVC conduit for all LED in-grade lights.
5. Re: C100: Bollards lights will not fit two 2” PVC conduit stubs.
Is it acceptable to provide 1” PVC conduit for all bollard lights?
Yes, provide 1” PVC for all bollard lights.

6. Re: 13 1118 and C100: Per specifications, all electrical work for splash pad equipment is by the plumbing contract. Per C100 drawing, there is an electrical conduit feeding from splash pad cabinet to the existing pad-mounted service transformer. Which contract is responsible for this conduit?

Delete: Spec 13 1118 1.01, A, 1.b. Furnish and install all piping, valves, electrical, and accessory items shown and/or specified as needed to form complete operating system in conjunction with splash pad equipment.

Add: Plumbing contract shall furnish and install all piping, valves, and accessory items shown and/or specified as needed to form complete operating system in conjunction with splash pad equipment. All electrical work for splash pad equipment, including electrical conduit, is by the electrical contract. Plumbing contract shall furnish splash pad LED lights and associated accessories, as provided by Vortex (or approved alternate), for installation by electrical contract.

Why is the conduit running back to the service transformer and not the existing electrical panel box?

All connections should be made to the electrical box. C100 has been revised.

What size conduit and wire is required to feed the splash pad cabinet?

Per 13 1118, 2.03 A.5.: Electrical wiring shall be #18 AWG with a 600V rating. Provide 1" PVC conduit.

7. Re: Bid Form: Per the Electrical Bid Form there is an item for Hand Holes (Quantity = 4). No hand holes are shown on the drawing. Are hand holes required? If so, provide locations.
Hand holes are not required. Disregard detail 5 on L601. Electrical bid form revised to reflect quantity of zero.
8. Measurement and Payment: Electrical: The provisions of Pay Item 9C – 2" PVC Conduit shall apply to the specified ¾" and 1" conduit.
9. Detail 4 on L601 for Electrical Trench shall apply to all PVC conduit sizes (2" noted in detail).

ITEM 2. REVISED DOCUMENTS

See attached documents:

Revised C100

Revised Electrical Bid Form

SECTION 00 4112

BID FORM – ELECTRICAL WORK

TITLE: CITY OF PLATTSBURGH ARTS PARK
RECEIVING DATE AND TIME: 11:00 AM THURSDAY, NOVEMBER 19, 2020
OPENING DATE AND TIME: 11:10 AM THURSDAY, NOVEMBER 19, 2020

Attn. City of Plattsburgh
 Office of Community Development
 Attn: Matthew Miller, Director
 41 City Hall Place
 Plattsburgh, NY 12901
 (518) 536-7527

Date:

Submitted by:
 (full name)

(full address)

OFFER:

ITEM 1 – BID AMOUNT

PAY			ESTIMATED		
ITEM NO.	PAY ITEM DESCRIPTION	UNITS	QUANTITY	UNIT COST	TOTAL COST
1	GENERAL REQUIREMENTS	LS	1		
2C	TRENCH EXCAVATION AND BACKFILL	CY	100		
3C	6" SAND ENVELOPE	CY	25		
4C	UTILITY WARNING TAPE	LF	695		
5	LIGHTING FIXTURES AND POLES	EA	4		
6	BOLLARD LIGHT	EA	5		
7	LED IN GRADE LIGHTS	EA	5		
8	HAND HOLES	EA	0		
9.1C	2" PVC CONDUIT	LF	135		
9.2C	1" PVC CONDUIT	LF	225		
9.3C	¾" PVC CONDUIT	LF	335		
10C	ELECTRICAL WIRING	LF	695		
11	CONNECTION TO POWER SOURCE	EA	4		
12C	CAST IN PLACE CONCRETE FOOTINGS	CY	5		

PAY			ESTIMATED		
ITEM NO.	PAY ITEM DESCRIPTION	UNITS	QUANTITY	UNIT COST	TOTAL COST
13	ALLOWANCE #1	ALLOW	1	\$5,000	\$5,000
		BID TOTAL, ITEMS 1-13			

Note: Payment Items listed above by Item Number with the suffix "C" are contingency Payment Items, and are not subject to the accuracy of quantities specified in paragraph 1.3.D of Section 01025.

Total to complete **Electrical Work** (Items 1-13):

.....dollars
(in words)

(\$.....)
(in numbers)

in lawful money of the United States of America.

All applicable federal and State of New York taxes are included in the Bid Sum.

Included in the bid amount shall be a \$5,000 Field Allowance:

The City is required to make a "good faith effort" to provide contracting opportunities for both MBE and WBE subcontractors. As a result, bidders are encouraged to provide opportunities for NYS-certified minority-and women-owned businesses. The goal for this project is 30% MWBE participation. This applies overall to the DRI grant projects under the Streetscape and Riverfront Access projects, of which this park revitalization is one part. A GC bidding on the project, that happens to be an MBE or WBE, is acceptable and will fulfill the requirement for this project. Combinations are also acceptable and do not have to be an even 15%/15% split between MBE and WBE participants.

ITEM 2 - PROPOSED EQUIVALENTS

If the bidder proposes to use materials and equipment other than those specified, they shall list below any equivalents they proposes to use.

Materials and equipment not listed on this sheet and not proposed as equivalents in the bid may not be considered, evaluated, or accepted as equivalents after the bids are received.

SPEC. SECTION SPECIFIED ITEM PROPOSED EQUIVALENT

ITEM 3 - ACKNOWLEDGMENTS

Acknowledgment is hereby made of the receipt of the following Addenda:

Addendum No. _____ dated: _____

Addendum No. _____ dated: _____

Addendum No. _____ dated: _____

The foregoing proposal includes all supervision, taxes (if applicable), overhead (including bond and

insurance costs), profit and other considerations included in construction contract costs.

This offer shall be open to acceptance for forty five (45) days from the bid closing date.

If the Owner accepts this bid within the time period stated above, we will execute the Agreement within fourteen days of receipt of Notice of Award.

If this Bid is accepted, we will achieve substantial completion of the Project by August 20, 2021.

The following documents shall be submitted within seventy-two (72) hours of bid opening and made a condition of the Bid:

1. Bidder Qualifications.
2. List of Subcontractors: Include names of all Subcontractors and portions of the Work each Subcontractor will perform.

ITEM 4 - BID FORM SIGNATURES

Sign Bid Form, as follows:

- Sole Proprietorship: Signature of sole proprietor in the presence of a witness who will also sign. Insert the words "Sole Proprietor" under the signature. Notarize signature.
- Partnership: Signature of all partners in the presence of a witness who will also sign. Insert the word "Partner" under each signature. Notarize signature.
- Corporation: Signature of a duly authorized signing officer in their normal signatures. Insert the officer's capacity in which the signing officer acts, under each signature. Affix the corporate seal. If the Bid is signed by officials other than the president and secretary of the company, or the president/secretary/treasurer of the company, submit a copy of the by-law resolution of their board of directors authorizing them to do so, with the Bid Form in the bid envelope.
- Joint Venture: Signature of each party of the joint venture under their respective seals in a manner appropriate to such party as described above, similar to requirements for Partnerships.

BIDDER:

.....
(full name of firm)

.....
(if joint venture: full name of firm)

BY / TITLE:
.....

BY / TITLE:
.....

BY / TITLE:
.....

was hereunto affixed in the presence of:
.....
(Authorized signing officer)

(Seal)

ITEM 5 - CORPORATE RESOLUTION

RESOLVED that _____ be
(individual)

authorized to sign and submit the bid proposal of this corporation for the following project:

City of Plattsburgh – Arts Park

and to include in such bid proposal the certificate as to non-collusion required by section One Hundred Three-D (103-D) of the General Municipal Law as the act and deed of such corporation, and for any inaccuracies or misstatements in such certificate this corporate bidder shall be liable under the penalties of perjury.

The foregoing is a true and correct copy of the resolution adopted by

_____ corporation at a
meeting of its Board of Directors held on the _____ day of _____, 2020, and is still in full
force and effect on this _____ day of _____, 2020.

(SEAL OF THE CORPORATION)

Secretary

AARON J. OVIDS, P.E.
PRESIDENT

RMS

ROBERT M. SUTHERLAND P.C.
11 MAGDOUGH STREET,
PLATTSBURGH, NY 12901
518.561.6145(FH)
518.561.2496 (FX)
RMS P.C.COM

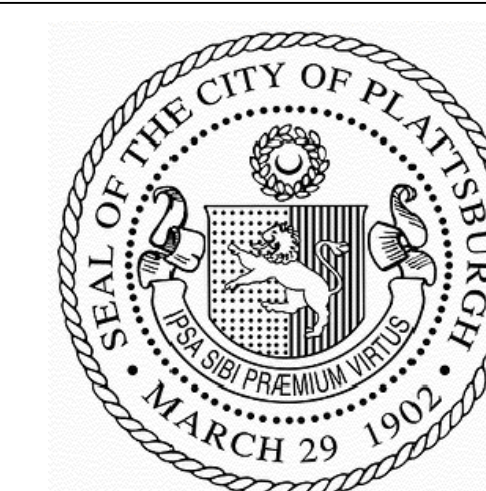

City of Plattsburgh, NY

Downtown Revitalization Initiative: Streetscape and Riverfront Access

Arts Park

REVISIONS				
NO	DATE	DESCRIPTION	DRAWN	CHK
0	10.26.2020	ISSUE FOR BID	RJM	DMS
1	10.30.2020	WATER SVC-DURKEE	ELG	RJM
2	11.12.2020	ELEC. CONDUIT/CXN.	ELG	RJM

SARATOGA ASSOCIATES PROJECT #: 18039.10

UNAUTHORIZED ALTERATION OR ADDITION TO THIS DOCUMENT IS A VIOLATION OF SECTION 2209 OF THE NEW YORK STATE EDUCATION LAW. © 2020 ALL RIGHTS RESERVED SARATOGA ASSOCIATES



DATE: 10.26.2020
DRAWN BY: RJM
CHECKED BY: DMS
PHASE: BID DOCS.

SITE UTILITY PLAN

C100

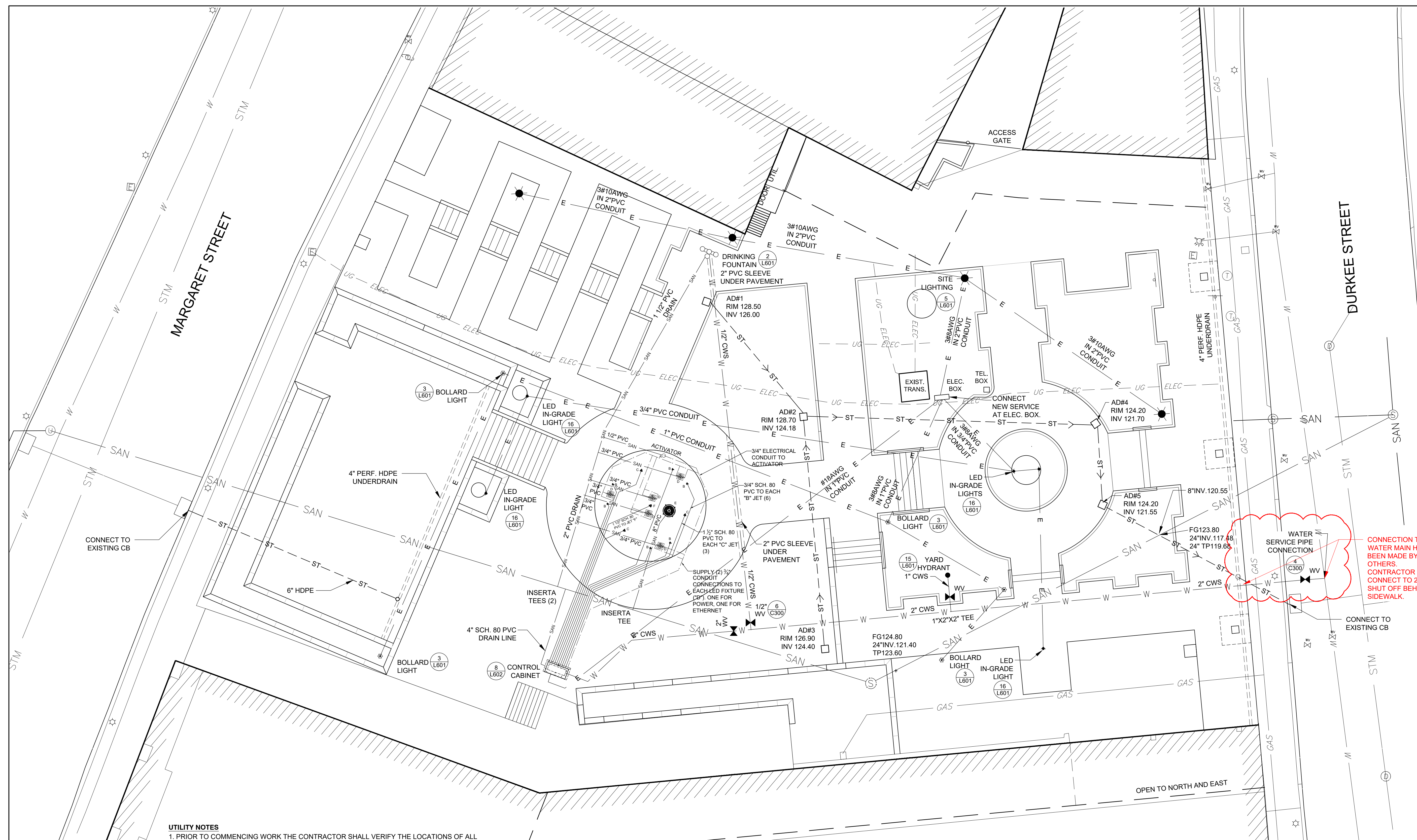

UTILITY NOTES

1. PRIOR TO COMMENCING WORK THE CONTRACTOR SHALL VERIFY THE LOCATIONS OF ALL UNDERGROUND UTILITIES. IT IS THE RESPONSIBILITY OF THE CONTRACTOR TO UTILIZE A LOCATING SERVICE TO VERIFY UNDERGROUND UTILITY LOCATIONS.

2. CONTRACTOR SHALL COORDINATE CLOSELY WITH DPW FOR THE REMOVAL OF THE EXISTING SANITARY LINE AND INSTALLATION OF NEW LINE WITHIN THE PROPERTY BOUNDARIES. AS MULTIPLE LATERALS AND DRAINS HAVE BEEN IDENTIFIED ON SITE (THAT MAY OR MAY NOT BE ABANDONED).

3. THIS PROJECT HAS 3 PRIME CONTRACTS. SEE SUMMARY OF THE WORK OF ELECTRICAL AND PLUMBING CONTRACTS BELOW:

3.01 SUMMARY OF WORK - ELECTRICAL CONTRACT

- A. Electrical trench and backfill work shall be performed under the Electrical Contract. Coordinate this work with other trades.
- B. All electrical relocation or new service requires City of Plattsburgh Permits and can be obtained from the Plattsburgh Municipal Lighting Department (PMLD). After obtaining the necessary permits the project construction schedule shall be coordinated with PMLD within 72 hours advance notice for all work.
- C. Furnish and install site electrical work including: electrical wiring and conduit, hand holes, light poles and fixtures, light bollards, in-grade LED lights, and connections to existing electrical transformer and electric box. Install splash pad LED lights (to be furnished by plumbing contractor).

3.02 SUMMARY OF WORK - PLUMBING CONTRACT

- A. Plumbing trench and backfill work shall be performed under the Plumbing Contract. Coordinate this work with other trades.
- B. All water and sewer relocation or new construction requires City of Plattsburgh Water and Sewer Permits and can be obtained from the City Building Inspector in coordination with DPW. After obtaining the necessary permits the project construction schedule shall be coordinated with DPW within 72 hours advance notice for all work.
- C. Furnish and install new stormwater management system including area drains, HDPE piping, connection to existing storm line and all fittings and accessories.
- D. Furnish and install new water supply system including cold water service to drinking fountain, yard hydrant and splash play controller, gate valves, drain valves, connection to existing water line, and all fittings and accessories.
- E. Furnish and install splash pad, including controller, splash pad features, play safe drain, and all fittings and accessories. Splash pad LED lights and accessories to be furnished by plumbing contract for installation by electrical contractor See other trades for splash pad pavement and electrical work. Coordinate work with other trades.
- F. Furnish and install new PVC drain lines, tee fittings, and connection to existing sewer main.

UTILITY LEGEND

	18" AREA DRAIN (8 L601)
	SEWER PIPE TRENCH (12 L601)
	4" PERF. HDPE UNDERDRAIN (7 L600)
	STORM SEWER CLEANOUT (13 L601)
	EXISTING SANITARY LINE
	EXISTING ELECTRIC LINE
	PROPOSED ELECTRIC LINE (4 L601)
	PROPOSED SITE LIGHTING (1 L601)
	PROPOSED LIGHT BOLLARD (3 L601)
	PROPOSED LED IN-GRADE LIGHTS (16 L601)
	EXISTING WATER LINE
	PROPOSED WATER LINE (2 C300)
	EXISTING GAS LINE

